

# TF HD SERIES

The TF HD auger for skid loaders and wheel loaders with SAE J2513 mount is designed for heavy-duty applications with high radial loads.

The QM Heavy Duty support protects the gearbox by transferring forces to the structure, while the patented double-pin coupling allows operation in locked mode with dedicated tools.

Versatile, it is suitable for construction, green maintenance and agriculture.



PRICE LIST			
TF1 HD	TF2 HD	TF3 HD	TF4 HD
£3,040	£3,485	£4,235	£4,795

## STANDARD EQUIPMENT

Ultra-compact and robust housing that encloses all components inside

Front and rear openings for easy access to the internal components for improved maintenance

Front and rear protective guards

Auger support with cradle to keep the equipment stable during transport

High-quality coating for greater resistance to impacts and wear

Heavy-duty interface support between gearbox and tools, resistant to high radial loads (price +15%)

Planetary gearbox for high performance even with low hydraulic flow (only for TF2 HD, TF3 HD, TF4 HD)

Hydraulic hoses L=2500

Standard shock relief valve to protect the hydraulic motor from pressure spikes

Provision for machine mount with reversible pendulum, usable free for drilling operations or locked for heavy-duty applications with tools such as log splitters or stump grinders (QM patented)

For a complete list of all the standard features of this auger, scan the QR code at the top of the page or visit [qm-agri.com](http://qm-agri.com)

	Oil Flow l min/max	Max Press. bar	Max Torque Nm	Speed rpm/l	A mm	B mm	C (hexagon) mm	Weight kg	Ø Max Drill. Ø mm
TF1 HD	18 / 50	210	1350	2,5	275	585	50	123	400
TF2 HD	30 / 60	205	2600	1,1	325	715	50	153	600
TF3 HD	50 / 90	240	4700	0,8	375	940	50	243	800
TF4 HD	50 / 90	240	6000	0,7	375	940	70	248	1000

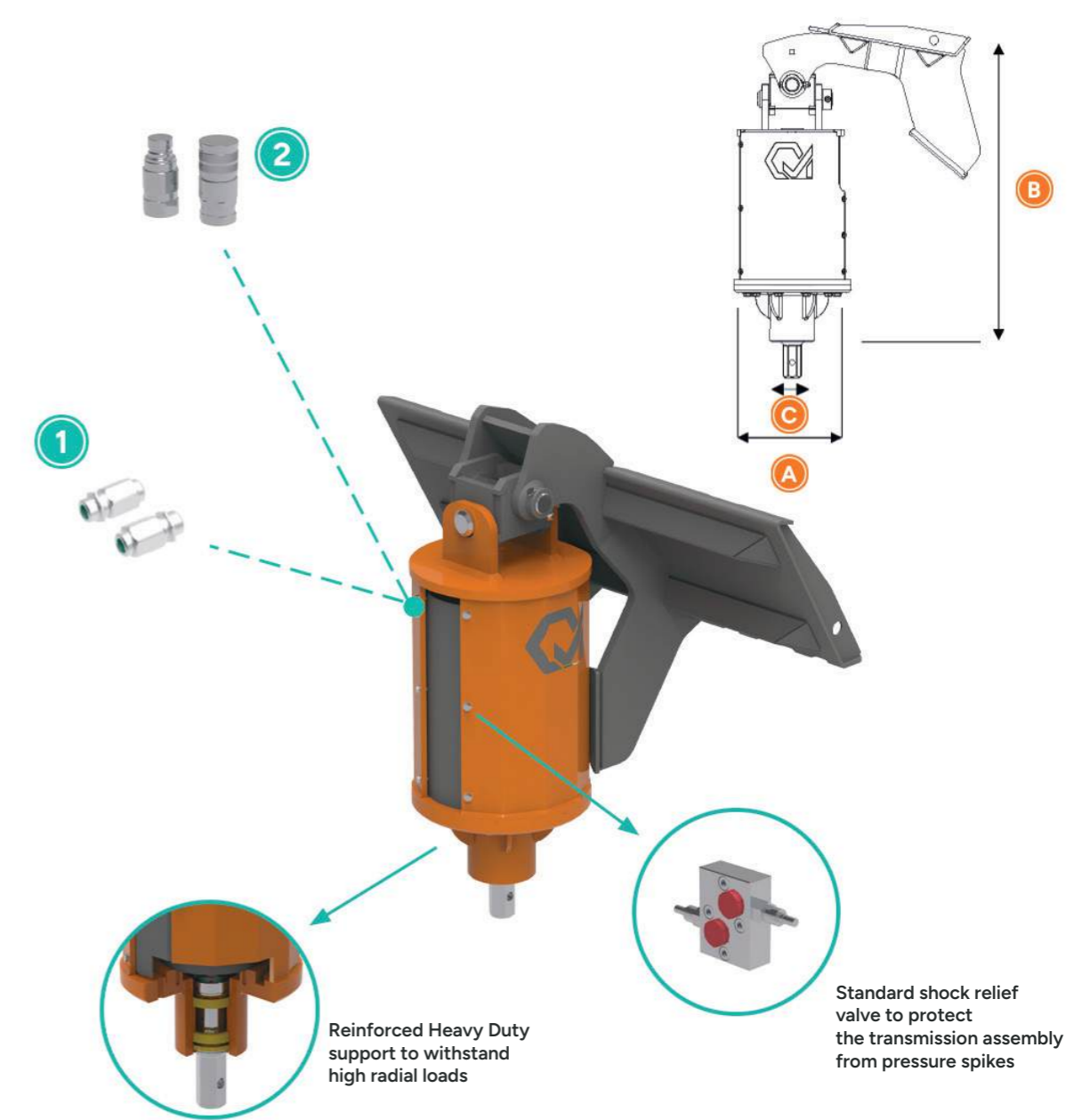

## OPTIONAL EQUIPMENT

1	FLOW REDUCERS	2	FLAT FACE QUICK COUPLERS**
	Recommended for carrier machines where the hydraulic flow rate exceeds the value indicated in the technical specifications (especially with HIGH FLOW)		Couplers 3/8"
	£105		Couplers 1/2"
			Couplers 3/4"
			£68
			£85
			£200

\*\* Different quick couplers from those indicated can be supplied upon request.  
All data are intended WITHOUT MACHINE MOUNT. Dedicated machine mounts available upon request.  
FOR HIGH FLOW MACHINES, PRESSURE REDUCERS ON HYDRAULIC LINES ARE RECOMMENDED