

TL HD SERIES

The TL HD bidirectional hydraulic auger for excavators from 0.8 to 10 tons is designed for heavy-duty applications with high radial loads.

The QM Heavy Duty support protects the gearbox by transferring forces to the structure, while the patented double-pin coupling allows operation in locked mode with dedicated tools.

Versatile, it is suitable for construction, green maintenance and agriculture.



PRICE LIST			
TL1 HD	TL2 HD	TL3 HD	TL4 HD
£2,475	£2,975	£3,510	£4,000

STANDARD EQUIPMENT

Ultra-compact and robust housing that encloses all components inside	Planetary gearbox for high performance even with low hydraulic flow (only for TL2 HD, TL3 HD, TL4 HD)
Front and rear openings for easy access to the internal components for improved maintenance	Standard shock relief valve to protect the hydraulic motor from pressure spikes
Front and rear protective guards	Provision for machine mount with reversible pendulum, usable free for drilling operations or locked for heavy-duty applications with tools such as log splitters or stump grinders (QM patented)
Hexagonal drive shaft for quick tool replacement	
High-quality coating for greater resistance to impacts and wear	
Heavy-duty interface support between gearbox and tools, resistant to high radial loads (price +15%)	

For a complete list of all the standard features of this auger, scan the QR code at the top of the page or visit qm-agri.com

	Excavator tons	Oil Flow l min/max	Max Press. bar	Max Torque Nm	Speed rpm/l	A mm	B mm	C (hexagon) mm	Weight kg	Ø Max Drill. mm
TL1 HD	0.8 / 3.0	18 / 50	210	1350	2,5	275	580	50	75	400
TL2 HD	3.0 / 5.0	30 / 60	205	2600	1,1	325	775	50	110	600
TL3 HD	5.0 / 7.0	50 / 90	240	4700	0,8	375	940	50	180	800
TL4 HD	7.0 / 10.0	50 / 90	240	6000	0,7	375	940	70	185	1000

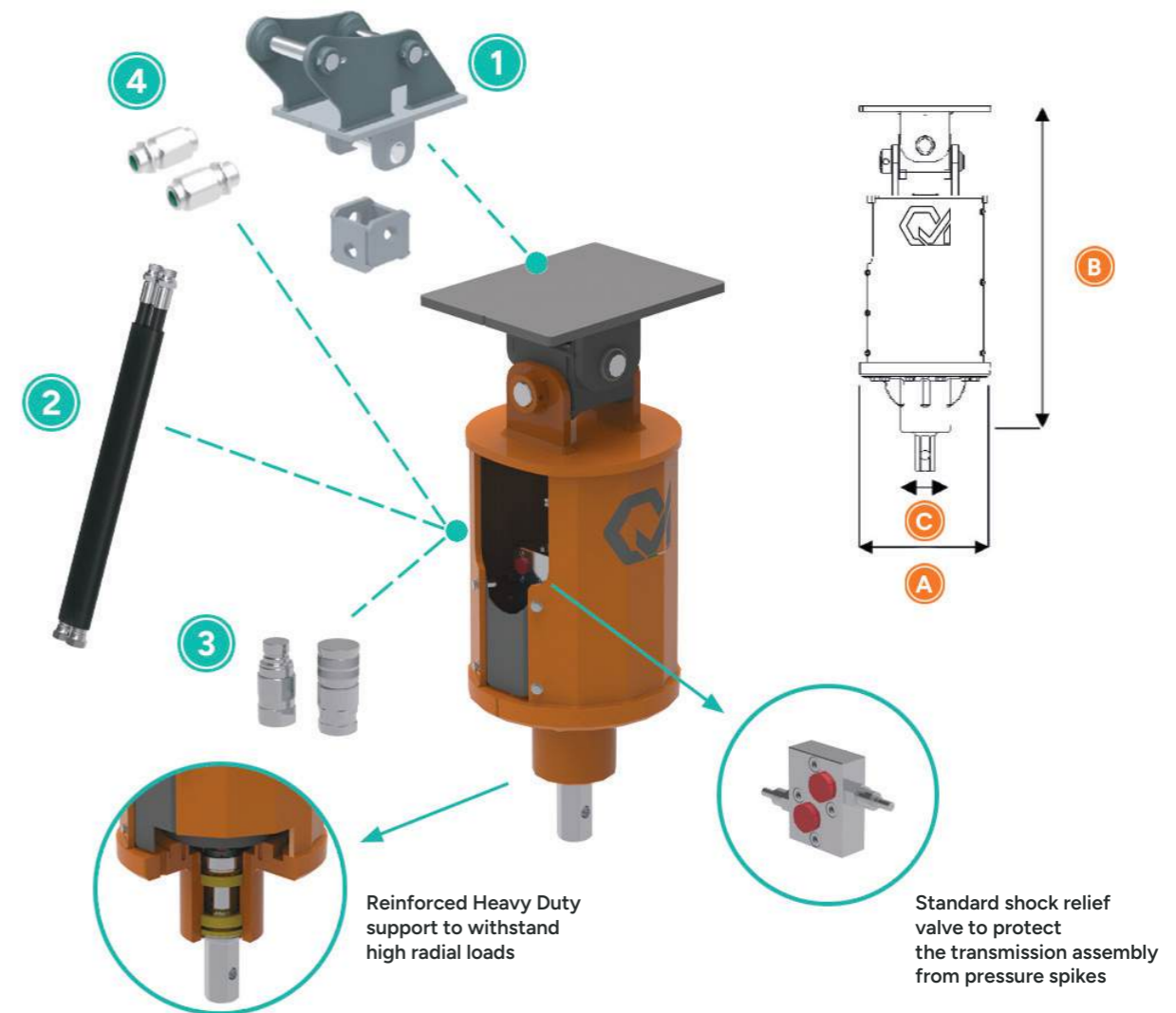

OPTIONAL EQUIPMENT

1 MACHINE MOUNT WITH PINS INCLUDED	
for carrier machine 0.8 / 1.8 tons	£210
for carrier machine 1.8 / 3.0 tons	£225
for carrier machine 3.0 / 4.0 tons	£250
for carrier machine 4.0 / 5.0 tons	£280
for carrier machine 5.0 / 6.0 tons	£330
for carrier machine 6.0 / 8.0 tons	£375
for carrier machine 8.0 / 10.0 tons	£435
2 HYDRAULIC LINE KIT*	
Hose 1/2" - L= 1500mm	£110
Hose 1/2" - L= 2000mm	£130
Hose 3/4" - L= 2000mm	£160
3 FLAT FACE QUICK COUPLERS**	
Couplers 3/8"	£68
Couplers 1/2"	£85
Couplers 3/4"	£200
4 FLOW REDUCERS	
Recommended for carrier machines where the hydraulic flow rate exceeds the value indicated in the technical specifications	£105

*A richiesta si possono fornire lunghezze diverse da quelle indicate
 ** A richiesta si possono fornire innesti rapidi diversi da quelli indicati

Tutti i dati sono da intendersi SENZA ATTACCO MACCHINA. A richiesta attacchi macchina dedicati

AUGERS
TL HD SERIES

AUGERS
TL HD SERIES